

2016 Neighborhood Traffic Calming Project Application

Arterial

Application Due ON or BEFORE March 7th, 2016

Neighborhood: COMSTOCK

Name: Elaine Thorne Phone: 509-321-7693

Address: 1102 East 39th Ave City: Spokane State: WA

Zip: 99202 Email: Elainethorne1967@gmail.com

Neighborhood Chair Signature: Elaine M Thorne

If the project falls on the boundary between your neighborhood and another neighborhood please inform the Chair to receive acceptance from the Neighborhood Council for project requested:

Bordering Neighborhood Chair Signature: _____

Instructions: Choose only one problem and one suggested solution to the problem. If you choose a feature that landscaping would be included, choose landscaping along with the other solution. Please refer to the [Traffic Calming Toolbox](#) to guide identifying the perceived problem as well as the appropriate solution. At the end of the application please provide pictures, maps and any other information that will help to identify the problem area you are applying for. Please remember all traffic issues will be subject to review by City of Spokane staff and are subject to engineering standards.

PROJECT LOCATION:

Be specific as possible: Intersection of West 37th Ave and S Bernard Street crosswalk with sidewalk installation and ADA ramp at #307 West 37th corner lot facing S Bernard

Intersection of West 37th Ave and S Bernard Street crosswalk with sidewalk installation and ADA ramp at #307 West 37th corner lot facing S Bernard

Project Rank: Rank project against arterial project, there can only be one number 1 project in your neighborhood. ☒ 1 ☐ 2

Perceived Problem:

☒ **SPEEDING ISSUE**

Suggested Solutions:

- | | | |
|---|---|--|
| <input type="checkbox"/> Textured or Colored Pavement | <input checked="" type="checkbox"/> On-Street Parking: Parallel or Angled | <input type="checkbox"/> Modern Roundabout |
| <input type="checkbox"/> Narrowed Lanes | <input type="checkbox"/> Bulb Out/Neckdown/Curb Extension | <input type="checkbox"/> Chicanes |
| <input type="checkbox"/> Traffic Islands & Medians | <input type="checkbox"/> Landscaping or Street Trees | <input type="checkbox"/> Speed Feedback Sign |
| <input type="checkbox"/> Reduced Corner Radii | <input type="checkbox"/> Gateway | |

☐ Signage; describe type: _____

☐ Pavement Markings/Stencils; describe type: _____

Perceived Problem:

☒ SAFETY ISSUE

Suggested Solution:

☒ In-fill Sidewalks ☒ Bike Lanes ☒ Crosswalk

Perceived Problem:

☒ TRAFFIC VOLUME ISSUE

Suggested Solution:

☐ Turn Restrictions ☐ Other: _____

Project Cost:

Instructions: Projects must be no more than \$40,000; use the Traffic Calming Toolbox to get an estimated cost for your chosen suggested solution. If the requested project is over \$40,000 please identify potential matching funds (e.g. gifts, CDBG, Safe Routes to School, etc.): \$40,000. Projects may be more than \$40,000, if possible a neighborhood can phase a project over multiple years to complete a project, and if funds are available City Council may choose to fund an entire project even if it is over the \$40,000 allotted.

Additional Information:

Instructions: Please check *all* that apply to the project area or on the street segment of the project.

Pedestrian Generators:

☒ School(s) ☐ Park ☐ Library ☐ Community Center ☐ Business Center

☐ Other (please describe): Pedestrians, runners to High Drive and Bluffs

Comprehensive Plan (Chapter 4: Transportation):

Instructions: Access the City of Spokane's Comprehensive Plan to identify if the projects roadway is on the currently adopted [Planned Bikeway Network Map \(Map TR 1\)](#), if location is on Map TR 1, (please check below the designated bike facility as stated on the map). Please check the [Draft Pedestrian Priority Map](#) to see if the area you are applying for is in a Pedestrian Priority area. Check *all* that apply.

☒ On Planned Bikeway Network Map; as a: ☒ Located within a Draft Pedestrian Priority Area

☐ Shared Roadway ☐ Bike Lane ☐ Marked/Shared Roadway

☐ Shared Use or Multiuse Path ☐ Bicycle Blvd Roadway

Unusable Sidewalk Sections:

Instructions: Identify any unusable sidewalk sections in or near your projects.

- ☐ Broken up/heaved sidewalk ☒ Lack of ADA accessibility ☐ Blocked sections
☐ Other: _____

Unique Roadway Geometry:

Instructions: Identify any unique roadway geometry (i.e. restriction or visibility) in project area, check *all* that apply.

- ☐ Sight Restrictions ☐ Offset Intersection ☐ Other: _____

Transit Information:

Instructions: Please identify transit stops or routes that are near your project. For any bus stop and/or any bus information please contact Mike Hynes of Spokane Transit Authority at mhynes@spokane.net or 325-6059.

- ☐ Near Bus Stop; approximately how close? ☒ At Bus Stop; Stop # 37TBERWN ☒ On a Route; Route # 43
☐ Near a Bus Route; how close? _____

Additional Information:

Instructions: Please include a written description with any additional information such as a Google map, pictures and other helpful information. Be specific and make sure your described location is correct.

West 37th Ave and South Bernard Street intersection has heavy traffic from commuters and parents taking children to and from school. There is currently no cross walk at West 37th and S Bernard as there is no sidewalk on the corner property of 307 West 37th Avenue. There is a sidewalk immediately adjacent to the property at 3718 S Bernard that extends toward West 40th Avenue. The property of 307 West 37th Avenue has a gravel walkway that pedestrians are using because there is no sidewalk. Parents have voiced concerns about crossing Bernard using West 37th because there are young children crossing the busy intersection to Jefferson Elementary School when there is dense traffic and no crosswalk. There is bus stop 37TBERMEM on the corner of Bernard and West 37th Avenue but to cross the street to the opposite side of Bernard there is no crosswalk. There is also a major bike route on the master bike plan which is supposed to be a bike lane on both S Bernard and also on West 37th Avenue. This intersection is part of the pedestrian plan and there are ADA ramps on eastern side of West 37th Avenue and Bernard on both sides. There is a plan to infill the eastern side of South Bernard as funds become available. Several residents have installed sidewalk from 37th Street south on Bernard toward High Drive This project would extend the sidewalk area already established by citizens.

Sidewalk Project from 307 West 37th Ave on the S Bernard border to 3718 S Bernard with crosswalk crossing Bernard to 37th Avenue.

The East side of S Bernard will receive fill in sidewalk as funds become available so there will be sidewalk from 29th Ave to 40th Avenue on Bernard. However the West side of Bernard has sporadic sidewalk installed. This project would allow for a missing segment of sidewalk to be installed so a crosswalk could be constructed at 37th and Bernard.



<https://www.google.com/maps/@47.6208789,-117.4164227,122m/data=!3m1!1e3>

There is a sidewalk from West 37 extends to S Bernard on the east side of 37th Avenue and Bernard only. There is no cross walk located at West 37th Avenue and South Bernard, although school children cross the road here.

There is heavy traffic from Bernard traveling South then turning left onto West 37th Avenue. There is also heavy traffic coming from Bernard traveling North then turning right onto 37th Avenue. Traffic notably increases prior to school opening and closing when parents are driving students to school and commuter traffic is also heavier.

There is a gravel walkway at the corner lot of 307 West 37th Ave which borders the property of 3718 S. Bernard. Sidewalk then extends from 3781 S Bernard to to 3918 S Bernard .

Desired outcome would to have sidewalk installed on the 307 W 37th Property facing Bernard.
A crosswalk would be installed at 37th and Bernard. An ADA ramp would also be installed on the corner of the 307 W 37th Ave property.



<https://www.google.com/maps/@47.6205951,-117.4158423,254m/data=!3m1!1e3>

307 West 37th Avenue corner lot bordering 37th and S Bernard- has gravel walkway that leads into sidewalk on adjacent property at 3718 S Bernard. https://www.google.com/maps/@47.6206616,-117.4166692,3a,90y,282.25h,63.67t/data=!3m6!1e1!3m4!1sAbLHkMw9Lls_NPjMtl8bEg!2e0!7i13312!8i6656



When funding became available it is requested that sidewalk on the eastern side of Bernard would then begin infill beginning at 37th and Bernard intersection at 308 W 37th Avenue to W 36th Avenue. This is estimated as 300 feet of sidewalk.



Looking Northward on South Bernard from intersection 37th and S Bernard

https://www.google.com/maps/@47.6208369,-117.4166713,3a,75y,346.24h,68.1t/data=!3m6!1e1!3m4!1sAwP_BM_WcGSEBa9QyS_ZLw!2e0!7i13312!8i6656!6m1!1e1

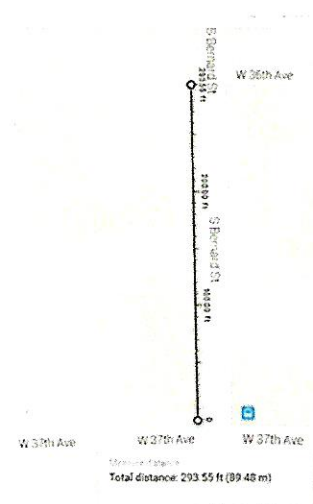

<https://www.google.com/maps/@47.6213529,-117.4167165,19z>

Supporting Documents for South Bernard and 37th Intersection Sidewalk project and Crosswalk 2016

There is a bus stop 37TBERWN located on West 37th Avenue and Bernard and also a few feet from the intersection of West 37th Ave and S Bernard Street 37TBEREM from the direction of the South Hill Park and ride toward downtown route.

http://www.transitunlimited.org/Map:STA_43

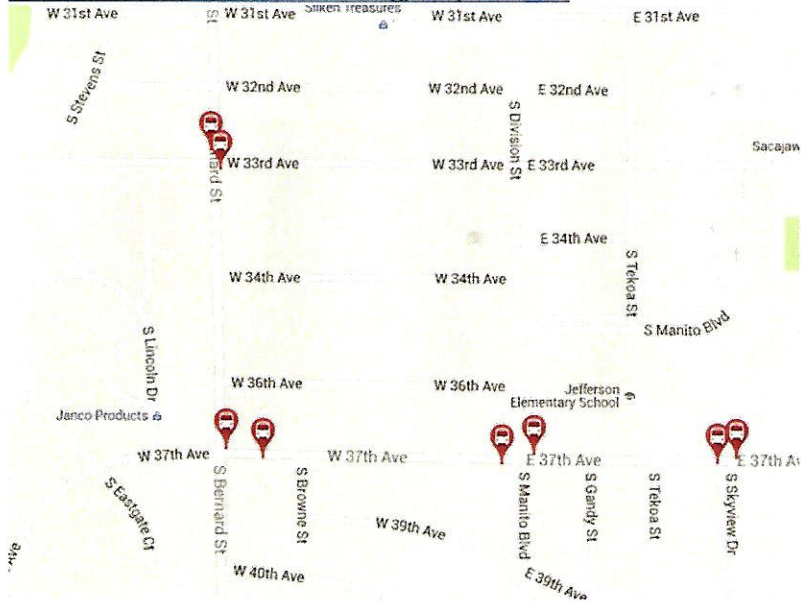

37TBERWN



There is sidewalk installed on the east side of S Bernard but lacking on the west side of Bernard at the intersection of 37th and Bernard. Property 308 W 37th avenue is located on the corner of West 37th and Bernard intersection.



Both S Bernard Street and West 37th Avenue are to have bike lanes per the Master Bike Plan (page 30)

<https://static.spokanecity.org/documents/projects/bikeplan/master-bike-plan-06-08-09.pdf>

